

REV.	DESCRIPTION	DRAWN	CHECKED	APPROVED
A	NEW RELEASE	JLZ 03/24/16'	~	

Material:

Housing Material: PBT, PA66, PA46, High Temp Nylon UL94V-0, Black and Grey Color

Contact Material: Phosphor Bronze 0.46mm, Round PIN

Plating: Gold Plating over Nickel

Electrical:

Voltage Rating: 125 V AC RMS

Current Rating: 1.5 Amp

Contact Resistance: 30mΩ Max.

Insulation Resistance: 500MΩ Min. @ 500 VDC

Dielectric Withstanding Resistance: 1000 VAC RMS 60Hz, 1 Min.

Mechanical:

Durability : 750 Cycles Min.

PCB Retention Force: 10 LBS Min.

Environmental:

Storage Temperature : -40°C to +85°C

Operation Temperature: -40°C to +85°C

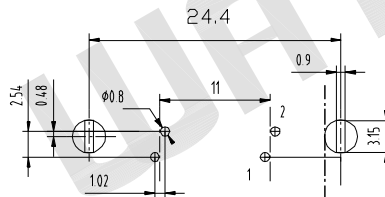
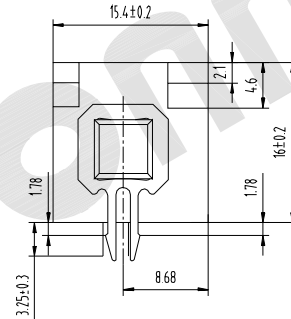
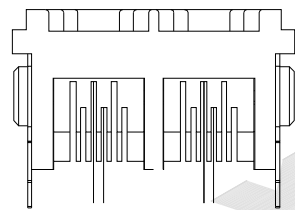
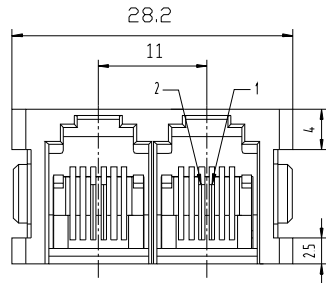

PC Board Layout
Component Side Shown

MJEE - X X X X X X X

No. of Positions	4,6,8	Positions Loaded	2,4,6,8	Ports	N - 1XN	Metal Pegs	0 - w/o Pegs 1 - w/ Pegs	Insulator Material	1 - PBT 2 - PA66 3 - PA46	Housing Color	1 - Black 2 - Grey 3 - Others	Gold Plating	1 - G/Fμ" 2 - 3μ" 3 - 6μ" 4 - 15μ" 5 - 30μ" 6 - 50μ"
------------------	-------	------------------	---------	-------	---------	------------	-----------------------------	--------------------	---------------------------------	---------------	-------------------------------------	--------------	---

GENERAL TOLERANCE	ANGLE TOLERANCE	PROJECTION		TITLE	RJ11 1X2, 6P2C, MODULAR JACK, VERTICAL	
X. ±0.60	X. ±5°	UNITS	mm	SHEET SIZE	A4	SERIES MJEE SERIES
.X ±0.38	.X ±3°	WAYCONN CO.,LTD				
.XX ±0.25	.XX ±2°					
DRAWING TYPE	CUSTOMER					
SCALE	1:1	SHEET	1 OF 1			
DRAWING NO.	MJEE - XXXXXXXX					