

Recommended PCB Layout
(PCB TOLERANCE ±0.1)

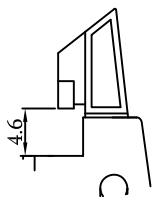

Short ejector

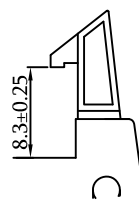

Long ejector

1. MATERIAL

1.1 INSULATOR: POLYESTER (UL 94V-0);
STANDARD: PA9T

1.2 CONTACT MATERIAL: COPPER ALLOY.

1.3 CONTACT PLATING: Au or Sn Over Ni

2. SPECIFICATION

2.1 CURRENT RATING: 3.0 Amp.

2.2 INSULATION RESISTANCE: 1000mΩ Min.

2.3 DIELECTRIC WITHSTANDING: 500VAC.

2.4 CONTACT RESISTENCE: 20mΩ Max.

2.5 OPERATING TEMPERATURE: -40°C TO +105°C.

EH 254 - XXX - XXX GX

Category

B=Box Header

Pitch

0.80=080

1.00=100

1.27=127

2.00=200

2.54=254

No. of PINS

2 x 03 ~ 2 x 32 PINS

Connector Type

S=Straight

R=Right Angle

M=SMT

Plating Standard: G0

G0: Gold Flash

G2: 1U" Gold

G3: 3U" Gold

G4: 5U" Gold

G5: 10U" Gold

G6: 15U" Gold

Gold SN: Tin

Packing Style

1. Tray

2. Tape & Reel

3. Tube

Insulator Material

1: PBT

2: PA6T

3: PA9T

4: LCP

PRODUCT TITLE: 2.54mm Pitch Ejector Header, SMT Type

UNLESS OTHERWISE SPECIFIED TOLERANCES

SCALE: 1/1

UNIT: mm



EH254-2XX-MXXGX-02

SIZE: A3

PAGE: 1 OF 1

RAV.A01

DECIMALS: ANGLES:
X :±0.5 X :±6°
X.X :±0.3 X.X :±3°
X.XX :±0.2 X.XX :±2°

WAYCONN ELECTRONICS